

UNIVERSITY OF CINCINNATI BULLETIN

ANNOUNCEMENT OF

The Graduate School



1961-1962

PUBLISHED BY THE UNIVERSITY OF CINCINNATI
VAN WORMER ADMINISTRATION BUILDING
CINCINNATI 21, OHIO

OF CINCINNATI

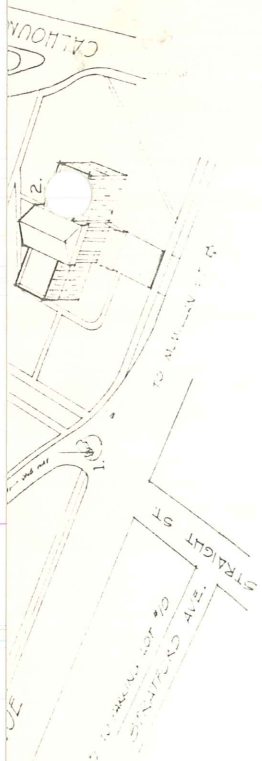

1. Entrance Building
2. Alphonso Taft Hall
3. Library
4. College of Education & Home Economics
5. College of Pharmacy
6. College of Arts
7. Hockey Field
8. Tennis Courts
9. Biology Building
10. Beecher Hall
11. Administration Bldg.
12. Cunningham Hall
13. McNicklen Hall
14. Union Hall
15. Applied Business Lab.
16. Health Service
17. Old Tech Building
18. Farmers' Council Lab.
19. Union Building
20. Student Center
21. Baldwin Hall
22. Chemistry Building
23. Physics-Math. Building
24. Wilson Memorial Hall
25. College of Applied Arts
26. Sturall Dormitory
27. Service Building
28. Power Plant
29. Aero Laboratory
30. Gymnasium
31. Centresh Field
32. James Gamble Nippert Memorial Stadium
33. Reed Shank Memorial Public Bath
34. Mead's Gymnasium
35. Memorial Residence Hall for Women
36. Y.M.C.A. Building
37. Practice Field
38. Baseball Field
39. Armory Fieldhouse
40. Classroom-Physical Education Building
- 41-42. French & Dubney Residence Halls for Men

examination of regional planning projects for energy development. 3 gr. cr. First semester, M 5:00-6:00. Mr. Hodgkins. (15-041-917)

GEOG. 991. SEMINAR: AREA PLANNING THEORY. Intensive study of selected complex planning theories and theoretical models. 3 gr. cr. First semester, M 5:00-6:00. Mr. Nash. (15-041-991)

GEOG. 992. SEMINAR: URBAN RENEWAL. Critical analyses of specific urban renewal programs, with emphasis on site problems and their relationships to architectural treatment and engineering design. 3 gr. cr. Second semester, M 3:00-6:00. Mr. Nash. (15-041-992)

Courses Offered in the Summer of 1961

GEOG. 332. URBAN GEOGRAPHY: SYSTEMATIC. Mr. Nash.

GEOG. 597. SPECIAL PROBLEMS IN GEOGRAPHY AND PLANNING. Mr. Nash.

GEOG. 997. RESEARCH IN GEOGRAPHY AND PLANNING. Mr. Nash.

GEOG. 372. THE GEOGRAPHY OF THE UNITED STATES AND CANADA. Mr. Wolf.

GEOG. 598. SPECIAL PROBLEMS IN GEOGRAPHY AND REGIONAL PLANNING. Mr. Wolf.

GEOG. 998. RESEARCH IN GEOGRAPHY AND REGIONAL PLANNING. Mr. Nash.

For further information, see the Announcement of the Summer School.

GEOLOGY

Head of Department: Professor WILLIAM F. JENKS (20 Old Tech); Professor CASTER (4-A Old Tech); Associate Professor SUNDERMAN (31 Old Tech); Assistant Professors DURRELL (35 Old Tech), LARSEN (B-1 Old Tech), R. G. SCHMIDT (53 Old Tech), KOUCKY (56 Old Tech).

This Department offers work leading to the degrees of Master of Science and Doctor of Philosophy.

A student admitted to graduate work in geology is expected to have satisfactorily passed one-year courses in physics and chemistry and an approved course in calculus or statistics. Biology is recommended as preparation for graduate work chiefly in paleontology. A summer field course in geology or its equivalent, such as a summer at a marine biological station for paleontology majors, is required before admission or early in the graduate program.

Interviews in order to determine advanced student.

The Geology intensive research on faunas of the C and geography

For Ad

*GEOLOG. 501, 502. Paleontology, stratigraphy, aton cr. each se (15-040-50)

*GEOLOG. 521, 522. Paleontology, stratigraphy, aton cr. each se (15-040-52)

GEOLOG. 470. A field excursion School; co Caster. (

*GEOLOG. 569. Paleontology, stratigraphy, aton cr. each se (15-040-56)

GEOLOG. 425, 426. Paleontology, stratigraphy, aton cr. each se (15-040-42)

GEOLOG. 444. Paleontology, stratigraphy, aton cr. each se (15-040-44)

GEOLOG. 470. Paleontology, stratigraphy, aton cr. each se (15-040-47)

GEOLOG. 472. Paleontology, stratigraphy, aton cr. each se (15-040-47)

GEOLOG. 481. Paleontology, stratigraphy, aton cr. each se (15-040-48)

GEOLOG. 505. Paleontology, stratigraphy, aton cr. each se (15-040-50)

*Open to graduate students in the Department of Geology

Interviews and early exploratory conferences are required in order to determine the student's prior training and aptitude for advanced studies and independent research.

The Geological Museum, in the same building, provides extensive research collections particularly with respect to the Paleozoic faunas of the Cincinnati region. The combined library of geology and geography contains more than 15,000 volumes.

For Advanced Undergraduate and Graduate Students

*GEOL. 301, 302. MINERALOGY. Crystallography, crystal chemistry, atomic structures, geochemistry, and systematics. 3 gr. cr. each semester. T Th 11:00; F 1:00-4:00. Mr. Koucky. (15-040-301, 302)

*GEOL. 321, 322. HISTORICAL GEOLOGY. T Th 8:00; Tu 2:00-5:00; S 9:00-12:00. 4 gr. cr. each semester. Mr. Caster. (15-040-321, 322)

GEOL. 350. ADVANCED GEOLOGY FIELD TRIP. A two weeks' field excursion between spring examinations and Summer School; conferences and report in fall semester. 3 gr. cr. Mr. Caster. (15-040-350)

*GEOL. 369. COMMON ROCKS. Hand specimen lithology and the genesis and alteration of rocks. 3 gr. cr. First semester, M W 9:00; Th 2:00-5:00. Mr. Sunderman. (15-040-369)

GEOL. 425, 426. INVERTEBRATE PALEONTOLOGY. 3 gr. cr. each semester. Lecture, T Th 9:30; laboratory, W 1:00-4:00. Mr. Caster. (15-040-425, 426)

GEOL. 444. PHYSIOGRAPHY OF WESTERN UNITED STATES. 3 gr. cr. Second semester, M W 10:00; F 1:00-4:00. Mr. Durrell. (15-040-444).

GEOL. 470. BASIC SEDIMENTOLOGY. 3 gr. cr. First semester, M W F 11:00 and 2 additional hours. Mr. Schmidt. (15-040-470)

GEOL. 472. PRINCIPLES OF STRATIGRAPHY. 5 gr. cr. Second semester, M W F 11:00 and 2 additional hours. Mr. Schmidt. (15-040-472)

GEOL. 481. GLACIAL GEOLOGY. 3 gr. cr. First semester, M W 10:00; F 1:00-4:00. Mr. Durrell. (15-040-481)

GEOL. 503, 504. SEMINAR. Required of all graduate students in geology. No gr. cr. M 4:00. Staff. (15-040-503, 504) Fee at the rate of 1 gr. cr.

*Open to graduate students from other departments with permission of the instructor and Advisory Department. No graduate credit for students in geology.

- GEOL. 511. PETROLOGY: IGNEOUS ROCKS. 4 gr. cr. First semester, T Th 11:00; M F 1:00-4:00. Mr. Larsen. (15-040-511)
- GEOL. 512. PETROLOGY: METAMORPHIC AND SEDIMENTARY ROCKS. 4 gr. cr. Second semester, T Th 11:00; M F 1:00-4:00. Mr. Larsen. (15-040-512)
- GEOL. 563. PRINCIPLES OF ECONOMIC GEOLOGY. Physical and chemical processes producing economic concentration in mineral deposits. 3 gr. cr. First semester, M W F 8:00. Mr. Jenks. (15-040-563)
- GEOL. 564. GEOLOGY OF ORE DEPOSITS. 3 gr. cr. Second semester, T Th 11:00; W 1:00-4:00. Mr. Jenks. (15-040-564)
- GEOL. 571, 572. INDIVIDUAL WORK IN GEOLOGY. Credit variable. Staff. (15-040-571, 572)
- GEOL. 574. THE POLARIZING MICROSCOPE. Crystal optics; use of the polarizing microscope for recognition of transparent substances in immersion media. 4 gr. cr. Second semester, M W 9:00; T Th 2:00-5:00. Mr. Sunderman. (15-040-474)
- GEOL. 589. STRUCTURAL GEOLOGY. 3 gr. cr. Second semester, M W 8:00; F 8:00-11:00. Mr. Jenks. (15-040-589)

Primarily for Graduate Students

- GEOL. 909, 910. ADVANCED MINERALOGY. 3 gr. cr. each semester. T Th 9:30. Mr. Koucky. (14-040-909, 910)
- GEOL. 921, 922. SEMINAR IN STRATIGRAPHIC GEOLOGY. 3 gr. cr. each semester. T Th 9:30. Mr. Schmidt. (14-040-921, 922)
- GEOL. 925, 926. ADVANCED MEGASCOPIC PALEONTOLOGY. Reading knowledge of German and French desirable. By the instructor's permission. 3 gr. cr. each semester. M W F 9:00. Mr. Caster. (14-040-925, 926)
- GEOL. 951. ADVANCED PETROLOGY: IGNEOUS ROCKS. 4 gr. cr. First semester, M W 10:00; W 1:00-4:00; F 8:00-11:00. Mr. Larsen. (14-040-951)
- GEOL. 952. ADVANCED PETROLOGY: METAMORPHIC AND SEDIMENTARY ROCKS. 4 gr. cr. Second semester, M W 10:00; W 1:00-4:00; F 8:00-11:00. Mr. Larsen. (14-040-952)
- GEOL. 971, 972. RESEARCH. Credit variable. Staff. (14-040-971, 972)
- GEOL. 973. SUMMER (FIELD OR LABORATORY) RESEARCH. Credit variable. (14-040-973)

445, Phy:
Geomorpho
Micropaleo
water; 963-

GEOL. 975.

Head of I
Professor ME

This Dep
of Arts and
Students
pleted an
German 30
Sciences, o

For

GERMAN 4
NINETE
taken
survey
and cor
semeste

GERMAN 5
ter. T

GERMAN 5
PARZER
each se

GERMAN 8
for stu
Gradu
have fi
the do
semest
(14-010

Courses Omitted in 1961-62

445, Physiography of Eastern United States; 449, Principles of Geomorphology; 480, Interpretation of Aerial Photographs; 924, Micropaleontology; 958, Seminar in Megatectonics; 960, Groundwater; 963-4, Advanced Sedimentology.

Course Offered in the Summer of 1961

GEOL. 973, 974. FIELD RESEARCH IN GEOLOGY. Staff.

GERMANIC AND SLAVIC LANGUAGES
AND LITERATURES

Head of Department: Professor GEORGE SCHOOLFIELD (228 McMicken); Professor MERKEL (229 McMicken); Associate Professor PAULS (639 Pharmacy).

This Department offers work leading to the degrees of Master of Arts and Doctor of Philosophy.

Students electing work in this Department should have completed an undergraduate major in German or its equivalent. German 301-2 and 421-2 in the McMicken College of Arts and Sciences, or their equivalents, are required.

For Advanced Undergraduate and Graduate Students

GERMAN 421, 422. HISTORY OF GERMAN LITERATURE TO THE NINETEENTH CENTURY. Required for students who have not taken this course or its equivalent as undergraduates. A survey of the literature from 800 A.D., with reading of excerpts and complete major works, lectures, and reports. 4 gr. cr. each semester. M W F 10:00. Mr. Schoolfield. (15-010-421, 422)

GERMAN 551, 552. RILKE-HOFMANNSTHAL. 4 gr. cr. each semester. Th 4:00-6:00. Mr. Schoolfield. (15-010-551, 552)

GERMAN 553, 554. HEINRICH VON KLEIST AND FRANZ GRILLPARZER. One semester will be devoted to each author. 4 gr. cr. each semester. W 4:00-6:00. Mr. Merkel. (15-010-553, 554)

Primarily for Graduate Students

GERMAN 801, 802. GERMAN READINGS. An elementary course for students wishing to acquire a reading knowledge of German. Graduate students who pass this course will be considered to have fulfilled the reading knowledge language requirement for the doctorate. No credit. Fee at the rate of $1\frac{1}{2}$ gr. cr. per semester. W 4:30-6:30. 353 McMicken. Mr. _____ (14-010-801, 802)

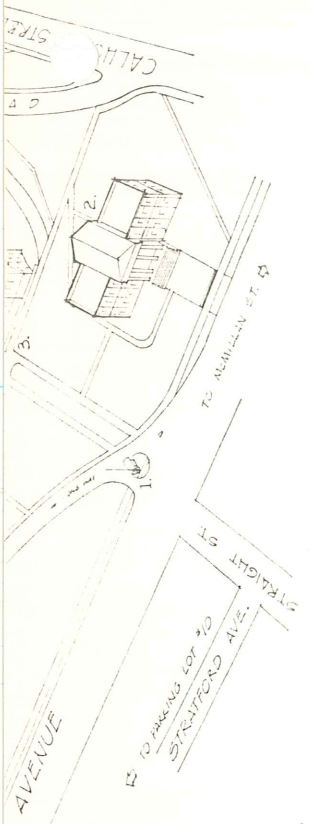

UNIVERSITY OF CINCINNATI BULLETIN

ANNOUNCEMENT OF THE

McMicken College of Arts and Sciences



1961-1962

PUBLISHED BY THE UNIVERSITY OF CINCINNATI
VAN WORMER ADMINISTRATION BUILDING
CINCINNATI 21, OHIO

UNIVERSITY OF CINCINNATI

- | | | |
|--|-----------------------------|---------------------------|
| 1. Entrance Building | 16. Health Service | 32. James Gamble |
| 2. Althouse Tuff Hall | 17. Field Tech. Building | Memorial Stadium |
| 3. Laboratory | 18. Fine Arts Council Lab. | 33. Peck, Shank Memorial |
| 4. College of Education & Home Economics | 19. Union Building | Aviation |
| 5. College of Pharmacy | 20. Swift Hall | 34. Men's Gymnasium |
| 6. Amphitheater | 21. Baldwin Hall | 35. McMicken W. Residence |
| 7. Hockey Field | 22. Chemistry Building | Hall |
| 8. Tennis Courts | 23. Physics-Math. Building | 36. Y.M.C.A. Building |
| 9. Biology Building | 24. Wilson Memorial Hall | 37. Practice Field |
| 10. Administration Bldg. | 25. College of Applied Arts | 38. Baseball Field |
| 11. Administration Hall | 26. Central Dormitory | 39. Aratony Fieldhouse |
| 12. Croningham Hall | 27. Science Building | 40. Classroom Building |
| 13. McMicken Hall | 28. Physics Laboratory | Educational Building |
| 14. Union Hall | 29. Aero Laboratory | 41-42. Freshman & Dining |
| 15. Applied Science Lab. | 30. Garage | Residence Halls for Men |
| | 31. Carlson Field | |

GEOLOGY

15-040

Professors JENKS (*Head of Department*, 20 Old Tech), CASTER (4-A Old Tech); Associate Professor SUNDERMAN (31 Old Tech); Assistant Professors DURRELL (35 Old Tech), LARSEN (B-1 Old Tech), R. G. SCHMIDT (33 Old Tech), KOUCKY (36 Old Tech).

The student may choose a concentration leading to the B.A. or B.S. in geology.

Geology 101-2 and 111-2 taken together are preliminary to all advanced courses in geology except 301-2 and 425-6. Students who have completed Geol. 103-4 and wish to major in geology must take 111 and 112.

To qualify for the B.A. degree in geology a student shall have completed Geol. 301-2, 217 (218, 219), 321-2, 501, 503-4, and 6 additional credits in geology, plus at least 18 credits in at least three of the following disciplines: chemistry, physics, zoology, botany, and mathematics.

To qualify for the B.S. degree with a major in geology a student shall include in his program Geol. 301-2, 217 (218, 219), 321-2, 501, 503-4, Chem. 101-2, 111-2, 6 to 9 credits of calculus and 6 to 10 credits of physics or zoology. In addition to the basic core of geology courses listed above, 12 credits in advanced courses in geology must be elected. A reading knowledge of German, French, or Russian is required prior to the senior year.

Both the B.A. and the B.S. majors may lead to graduate work in geology, usually considered essential for a professional career. A properly planned program may lead to the M.S. degree one year after obtaining the B.S. Typical programs may be obtained from the adviser.

For all B.S. candidates and all students planning geology as a profession, a six to eight weeks' summer field course or its equivalent is required. Alternative acceptable field training may be obtained by summer work at a marine biological station or with one of the geological surveys, or by summer field employment by a mining or oil company, with the approval of the adviser.

Each autumn all students majoring in geology are expected to attend a four-day field trip and should anticipate the cost of the trip, about \$35.

101-2. INTRODUCTION TO GEOLOGY. Geol. 101-2 and 111-2 form two parts of a single ten-credit course which satisfies the science requirement. Geol. 101-2 may be taken alone only with the instructor's permission. MWF 8:00. Mr. Durrell.

111-2. INTRODUCTION TO GEOLOGY LABORATORY. A laboratory course to accompany Geol. 101-2. MW 1:00-4:00; TTh 2:00-5:00. 2 cr. each sem. Mr. Durrell and assistants.

103-4. GENERAL
students not
fulfills the sci
with an eleme
8:00, laborato
Sec. III, F1:0

219. GEOLOGIC D
sion in May
during fall se
each number
mission of ins

301-2. MINERAL
structures, g
minerals. Pre
[1:00; F-1:00-
Th 2:00

321-2. HISTORIC
of the earth v
8:00; Tu 2:00

330. ADVANCED
sion between
Historical an
fall semester
Caster.

369. (1st sem.)
the genesis
or equivalent

425-6. INVERT
invertebrate
lent. or a c
W 1:00-4:00

444. (2nd sem
MW 10:00

470. (1st sem.
origin, tran
of sedimen
lents. MW

472. (2nd sem
and biostr
Geol. 470
Mr. Schmi

- 103-4. GENERAL GEOLOGY. An elementary course for general students not expecting to do further work in the subject; fulfills the science requirement only if taken in combination with an elementary course in another science. Lecture, TTh 8:00, laboratory, Sec. I, M 1:00-4:00; Sec. II, W 1:00-4:00; Sec. III, F 1:00-4:00. Mr. Sunderman.
219. GEOLOGIC DEMONSTRATION TRIP. A two weeks' field excursion in May and June, 1962. One-hour conference weekly during fall semester. (Alternates with Geol. 217 and 218; each number designates a different route.) Prerequisite: Permission of instructor. Conferences, M 10:00. Mr. Schmidt.
- 301-2. MINERALOGY. Crystallography, crystal chemistry, atomic structures, geochemistry, and systematics of the common minerals. Prerequisite: High-school or college chemistry. TTh 11:00; ~~F 1:00-4:00~~. Mr. Koucky.
Th 2:00-5:00
- 321-2. HISTORICAL GEOLOGY. The physical and biological history of the earth with particular emphasis on North America. TTh 8:00; Tu 2:00-5:00; S 9:00-12:00 4 cr. each sem. Mr. Caster.
330. ADVANCED GEOLOGY FIELD TRIP. A two weeks' field excursion between spring examinations and Summer School. Historical and regional geology. Conferences and report in fall semester. Prerequisite: Permission of instructor. Mr. Caster.
369. (1st sem.) COMMON ROCKS. Hand specimen lithology and the genesis and alteration of rocks. Prerequisite: Geol. 301-2 or equivalent. MW 9:00; Th 2:00-5:00. Mr. Sunderman.
- 425-6. INVERTEBRATE PALEONTOLOGY. Paleobiology of common invertebrate fossils. Prerequisite: Geol. 101-2, 111-2 or equivalent, or a course in biology, zoology, or botany. TTh 9:30; W 1:00-4:00. Mr. Caster.
444. (2nd sem.) PHYSIOGRAPHY OF WESTERN UNITED STATES. MW 10:00; F 1:00-4:00. Mr. Durrell.
470. (1st sem.) BASIC SEDIMENTOLOGY. Principles governing the origin, transportation, deposition, and subsequent alteration of sediments. Prerequisites: Geol. 301-2 and 469 or equivalents. MWF 11:00 and 2 additional hours. Mr. Schmidt.
472. (2nd sem.) PRINCIPLES OF STRATIGRAPHY. Stratigraphic and biostratigraphic principles and methods. Prerequisite: Geol. 470 or equivalent. MWF 1:00 and 2 additional hours. Mr. Schmidt.

481. (1st sem.) GLACIAL GEOLOGY. MW 10:00; F 1:00-4:00. Mr. Durrell.
501. (1st sem.) READINGS FOR SENIORS. Required of all seniors majoring in geology. Not open to other students. 2 cr. Staff.
- 503-4. GEOLOGY SEMINAR. Required of all juniors and seniors majoring in geology. No additional credit. M 4:00.
511. (1st sem.) PETROLOGY: IGNEOUS ROCKS. Prerequisite: Geol. 301-2 or equivalent. TTh 11:00; MF 1:00-4:00. 4 cr. Mr. Larsen.
512. (2nd sem.) PETROLOGY: METAMORPHIC AND SEDIMENTARY ROCKS. Prerequisite: Geol. 301-2 or equivalent. TTh 11:00; MF 1:00-4:00. 4 cr. Mr. Larsen.
563. (1st sem.) PRINCIPLES OF ECONOMIC GEOLOGY. Physical and chemical processes producing economic concentration in mineral deposits. MWF 8:00. Mr. Jenks.
564. (2nd sem.) GEOLOGY OF ORE DEPOSITS. TTh 11:00; W 1:00-4:00. Mr. Jenks.
- 571-2. INDIVIDUAL WORK IN GEOLOGY. Credit depends on amount of work done. May be entered either semester. Staff.
574. (2nd sem.) THE POLARIZING MICROSCOPE. Crystal optics; use of the polarizing microscope for recognition of transparent substances in immersion media. Prerequisite: Geol. 301-2 or permission of the instructor. MW 9:00; TTh 2:00-5:00. 4 cr. Mr. Sunderman.
589. (2nd sem.) STRUCTURAL GEOLOGY. Prerequisites: Geol. 301-2 and 321-2 or equivalents. MW 8:00; F 8:00-11:00. Mr. Jenks.

Omitted during 1961-62: 215, Economic Mineral Deposits; 443, Physiography of Eastern United States; 448, World Physiography; 449, Principles of Geomorphology; 480, Interpretation of Aerial Photographs; 566, Petroleum Geology.

GERMANIC AND SLAVIC LANGUAGES AND LITERATURES

15-010

Professors SCHOOLFIELD (*Head of Department*, 228 McMicken), MERKEL (229 McMicken); Associate Professor PAULS (639 Pharmacy); Assistant Professors SYRING (250 McMicken); Instructor MALYCKY (251 McMicken).

German 001-2, 011-2, 101-2, and 113-4 will not count toward a major in German. German 121-2, 301-2, and 421-2 shall be offered as part of the requirement toward a major in German.

All courses
ruary with th

253-4. COMPA
MWF 11:00

001-2. ELEM
011-2 mus
ment, bu
7 sections
MWF 1:00

011-2. ELEM
TTh 8:00
5:30. 2 c

101-2. INTER
complete
readings
years of
Mr. Mer

113-4. REAL
sciences,
011-2 or
MWF 8:

121-2. GER
001-2 an
9:50-11:5

Any of t
ment.

201-2. MO
and 011
Mr. Syr

301-2. INT
PERIOD
and 011
equiv

421-2. HIS
CENTU
MWF

501-2. RE
in Ger

591-2. SE
Mr. —